

PROPOSED RESIDENTIAL FLATS AT NEW DOOR NO. 15, SEETHAMMA COLONY EXTENSION, 3<sup>RD</sup> STREET, MADRAS - 600018.  
 RS. NO. 3839/6 part & 3839/7 part  
 DIVISION NO. ...  
 BLOCK NO. 75  
 PLOT NO. 49  
 OLD DOOR NO. 6

Planning Permit No. B 18234/32/95.  
**APPROVED**  
 SUBJECT TO THE CONDITIONS IN THIS OFFICE LETTER OVER HEAD WATER TANK.  
 FOR MEMBER SECRETARY  
 MADRAS METROPOLITAN  
 DEVELOPMENT AUTHORITY  
 MADRAS - 600 008.

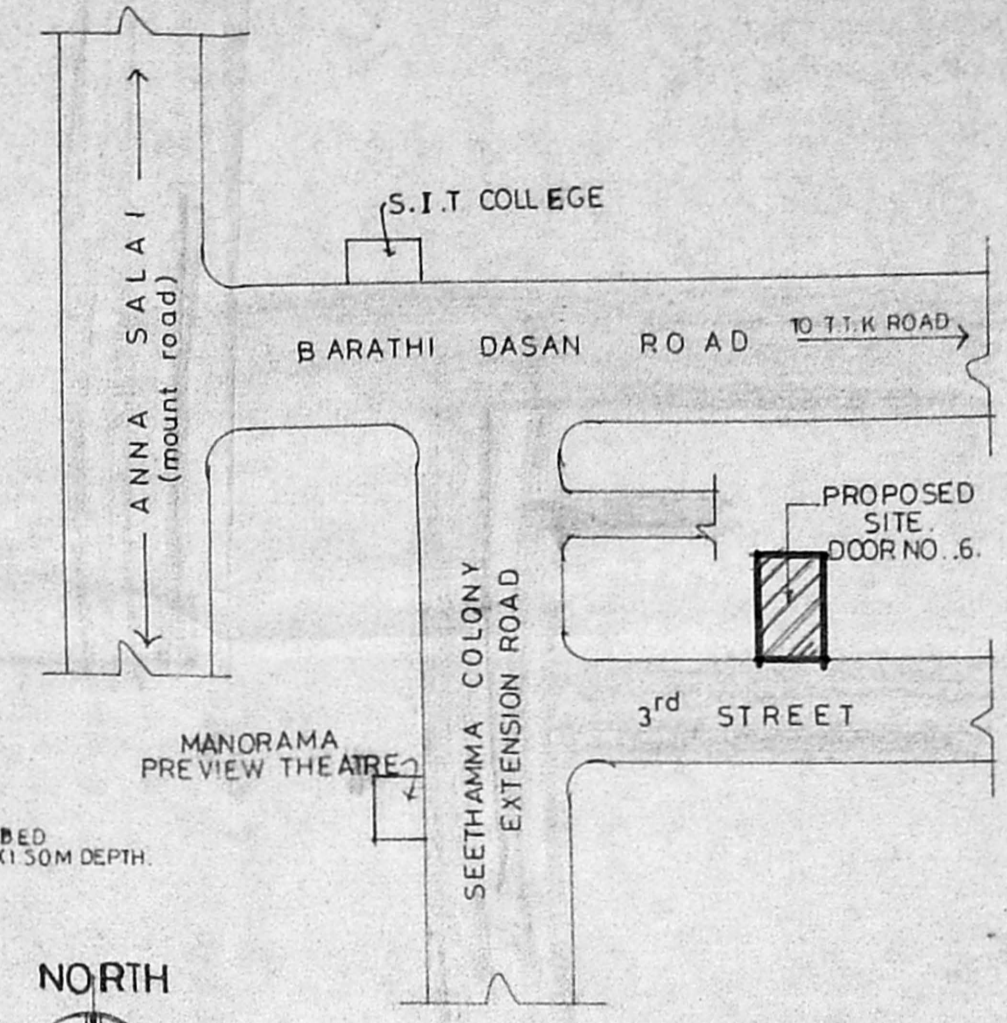
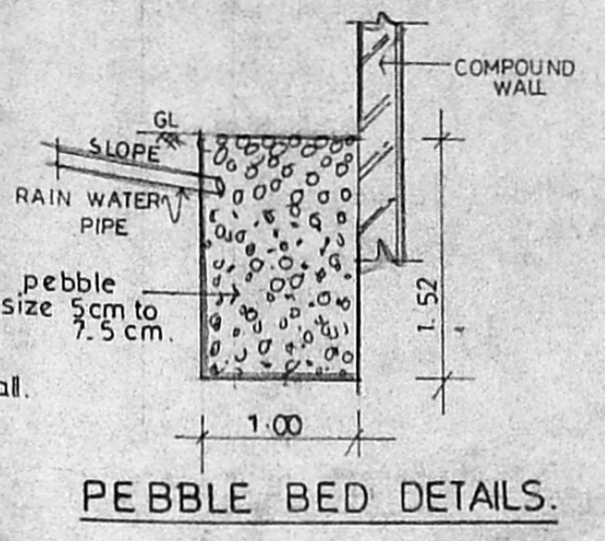

**LEGEND.**

MD..1.00 X 2.13	MAIN DOOR.
D1..0.91 X 2.13	DOOR.
D2..0.76 X 2.13	DOOR.
W..1.52 X 1.37	WINDOW.
W1..1.37 X 1.37	DOOR.
W2..1.00 X 1.37	DOOR.
KW..1.37 X 1.07	KITCHEN WINDOW.
V1..0.76 X 0.61	VENTILATOR.
FW..1.07 X 1.83	FRENCH WINDOW.

**AREA STATEMENT.**

PLOT AREA - 305.36 sq.m (or) 3287.00 s.ft  
 GROUND FLOOR AREA -  
 FLAT G1 AREA - 82.72 sq.m  
 COMMON AREA - 13.28  
 TOTAL - 96.00

TYPICAL FLOOR AREA (1<sup>ST</sup>, 2<sup>ND</sup>, 3<sup>RD</sup>)  
 FLAT T1 AREA - 102.123  
 COMMON AREA - 13.28  
 TOTAL - 115.403 X 3 = 346.21 sq.m

TOTAL BUILT UP AREA - 442.21  
 F.S.I - 1.468 times  
 PLOT COVERAGE - 38%

**SPECIFICATION.**

FOUNDATION - RCC COLUMN IN MIX 1:2:4.  
 ROOF LINTEL & SUNSHADE - RCC 1:2:4.  
 SUPERSTRUCTURE - 230 THK BRICK WALL IN C.M.1:5 & PLASTERED ON BOTH SIDES.  
 JOINERY - TEAK WOOD DOORS & TEAK WOOD FRAMED GLAZED WINDOWS.  
 FLOORING - MOSAIC.  
 WEATHERING COURSE - BRICK JELLY LIME CONCRETE.

**NOTE.**

PROPOSED ROAD BOUNDARY

SCALE - 1:100. DATE - 01.01.1995

ALL DIMENSIONS ARE IN METRES.

S. P. Venkatesan  
 SIGNATURE OF OWNER.

P. RAVI  
 LICENSED SURVEYOR CLASS I (No. B.A. 33)  
 CORPORATION OF MADRAS  
 22, ELLAIAMMAN COLONY, MADRAS-600 006

P. RAVI ARCHITECTS PRIVATE LIMITED  
 REGISTERED ARCHITECT, INTERIOR DESIGNER,  
 REGISTERED VALUERS & PLANNERS

